

ADesignStudio.

INSTALLATION NOTES

NOTE NL

NOTE NL
WITH TRIM



Sydney, Australia
studio@adesignstudio.com.au

CAUTION: TO PROTECT THE LED BOTH POWER AND RESIDUAL POWER TO THE DRIVER MUST BE AT ZERO BEFORE CONNECTING THE LIGHT FITTINGS. HOT PLUGGING THE FITTINGS CAN CAUSE LED FAILURE.

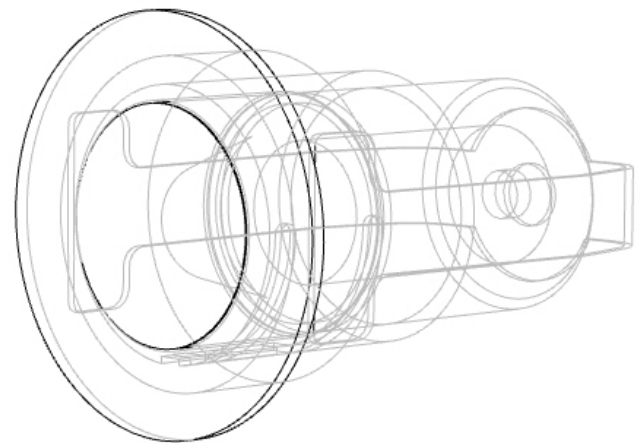
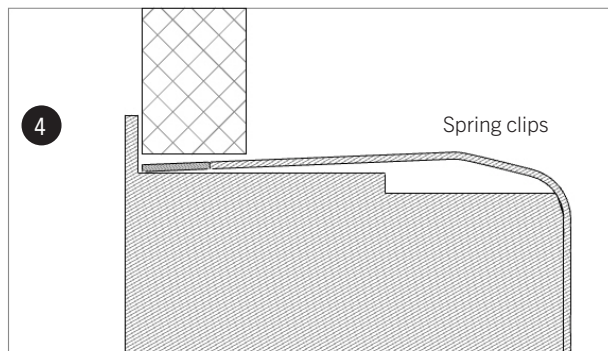
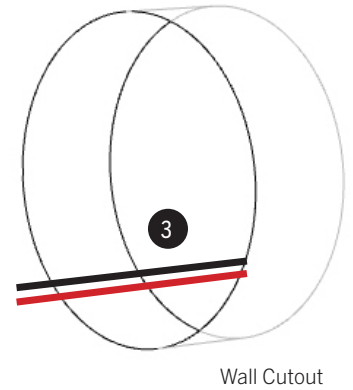
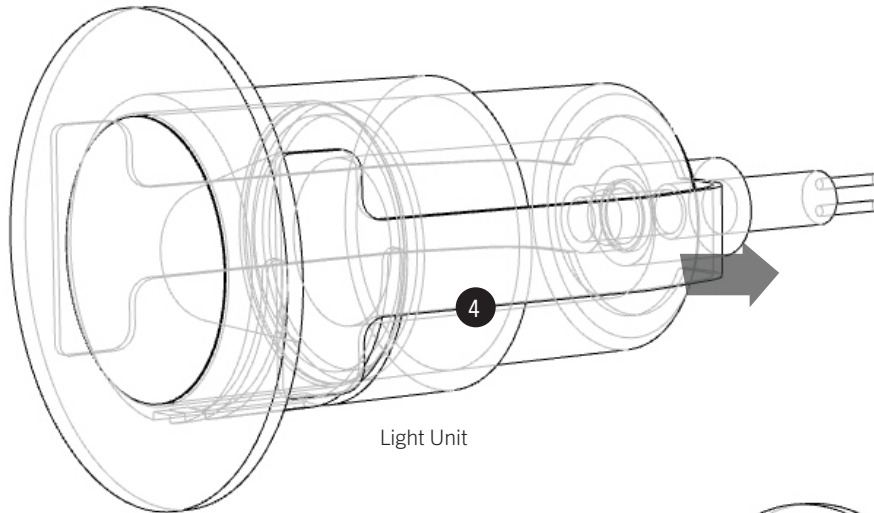
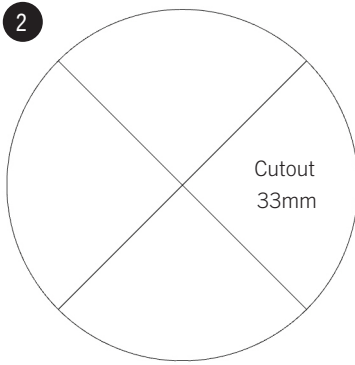

ATTENTION!

The safety of this fitting can only be guaranteed if these instructions are observed, during both installation and use. Please retain these instructions.

REMARKS

- When installing the system, make sure all current national regulations relating to installation are observed.
- When installing and / or working on the fitting, ensure that the power supply has been switched off.
- The fitting may in no way be modified or tampered with. Any modification may compromise safety, causing the appliance to become dangerous. ADesignStudio declines all responsibility for products that are modified.
- This appliance must be connected to an efficient grounding system in order to work safely and correctly.
- Contact a qualified electrician for installation.

ASSEMBLY INSTRUCTIONS

Caution: to avoid possible electrical shock, make certain electricity is shut off at main panel before wiring.

Do not connect 210-240V directly into the light fitting.

1. Install the driver remotely in an accessible, dry, and ventilated location. Rough in wiring beforehand if possible.
2. Cut the mounting hole.
3. Rough in cabling from the remote driver location to the fittings (if not already done). Make the electrical connections while respecting the poles. For IP fittings, wire connections must be waterproof. Wire according to the remote LED driver manufacturer's recommendations. Do not connect the fitting to live wires or mains voltage.
4. Hold in spring clips and slide the fitting through the cutout.
5. Ensure the fitting flange sits flush against the wall.
6. Power on once the fitting is fully installed.

CLEANING INSTRUCTIONS

Warning: Do not use alcohol or other solvents.

Use only a soft cloth to clean the luminaire.