

**ADesignStudio.**

+

**SARAH ELLISON.**

INSTALLATION NOTES

**ALCHEMY P1**



Canopies must be fastened to load bearing substrate or crossbeam

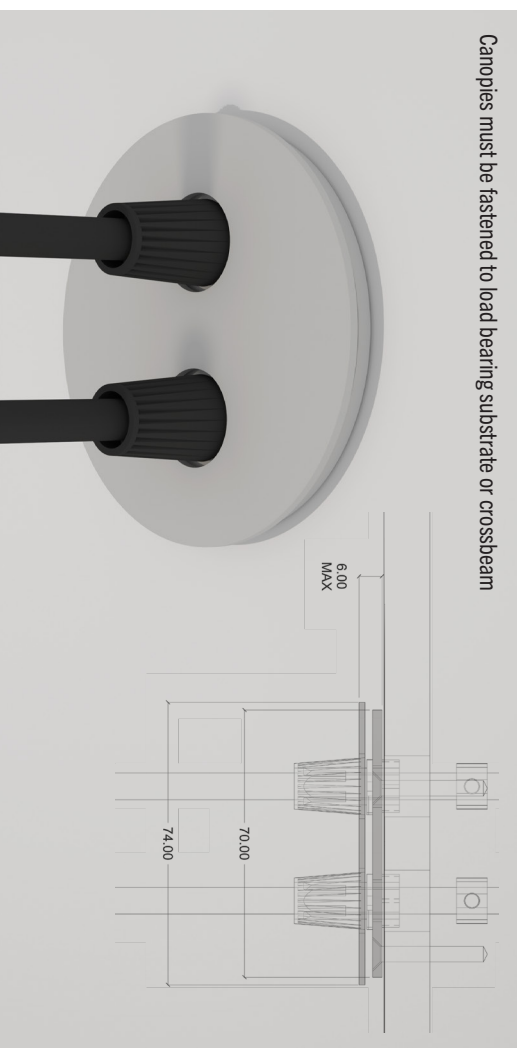

Sydney, Australia  
studio@adesignstudio.com.au

## TWO FLEX SUSPENSION

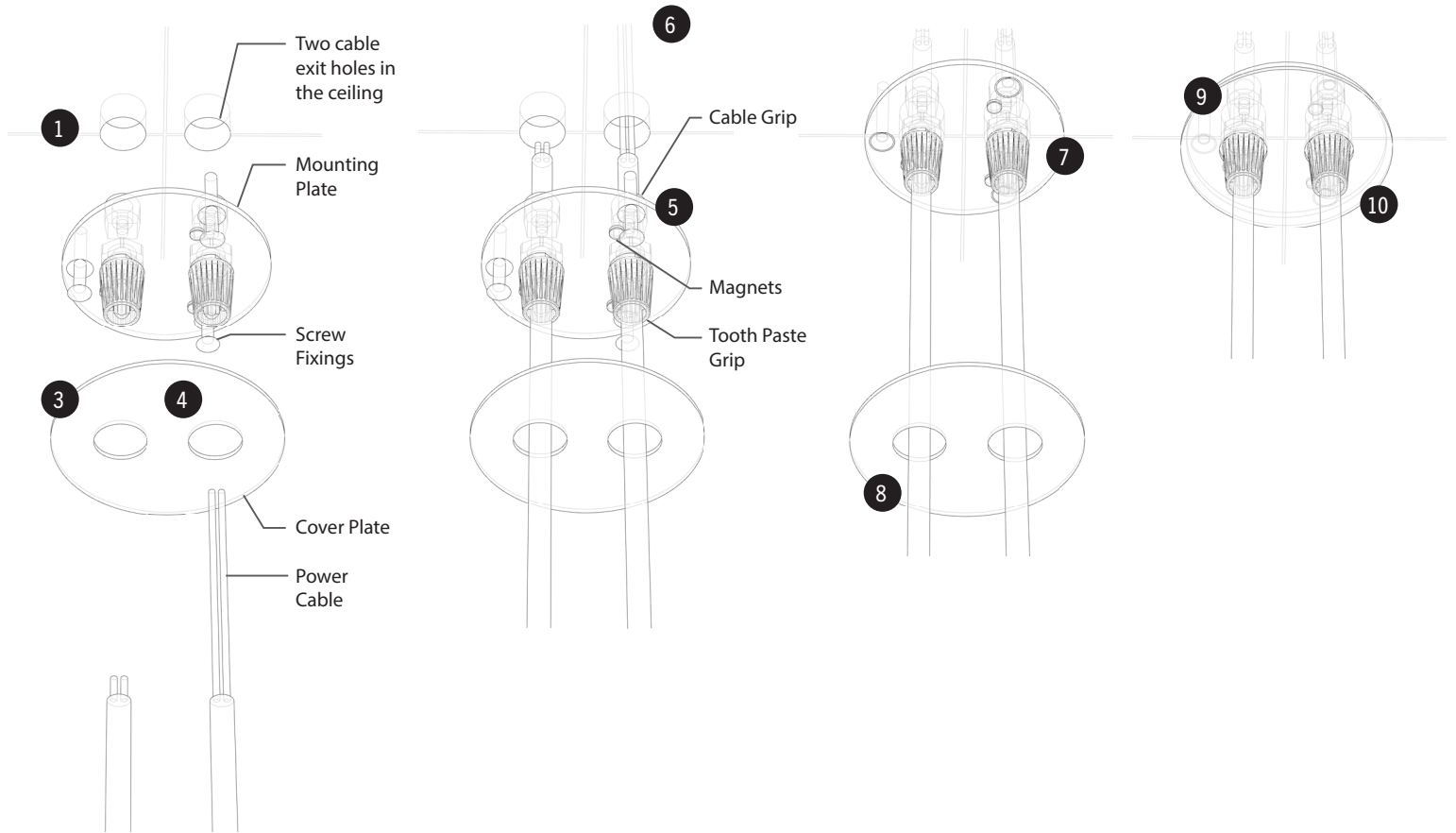

### ATTENTION!

The safety of this fitting can only be guaranteed if these instructions are observed, during both installation and use. Please retain these instructions.

### REMARKS

- When installing the system, make sure all current national regulations relating to installation are observed.
- When installing and / or working on the fitting, ensure that the power supply has been switched off.
- The fitting may in no way be modified or tampered with. Any modification may compromise safety, causing the appliance to become dangerous. ADesignStudio declines all responsibility for products that are modified.
- This appliance must be connected to an efficient grounding system in order to work safely and correctly.
- Contact a qualified electrician for installation.

### CLEANING INSTRUCTIONS

Warning: Do not use alcohol or other solvents. Use only a soft cloth to clean the appliance.

### ASSEMBLY INSTRUCTIONS

Caution: to avoid possible electrical shock, make certain electricity is shut off at main panel before wiring.

1. Cut a holes in the ceiling for the cable reticulation
2. Led driver to be mounted remotely in a dry, ventilated and accessible location.
3. Remove the magnetically attached cover plate
4. Thread both power cables through the cover plate in there corresponding holes and mounting plate
5. Use a cable grip and/or zip tie to secure the cable within the ceiling
6. Make a low voltage connection from the remote driver to the LED. Ensure correct polarities. Only one of the suspensions will be live. The other suspension will just be for suspension and alignment
7. Fix Mounting Bracket to the ceiling through counter sunk holes (fasteners not included)
8. Reinstall Cover Plate with magnets
9. Hang fitting with the cable suspension to the desired height
10. Use the toothpaste grip to secure the power feed and level the fitting